

# Quick Guide

This guide describes the basic printing procedures using the printer and this machine. In the next pages, the procedures for each step and particular cautions are explained. For safe and correct use, be sure to read Safety Information before using the machine.

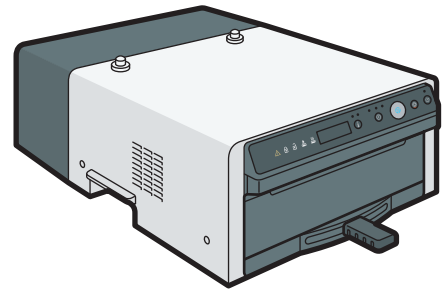

DSA121

## Guide to Components of the Finisher

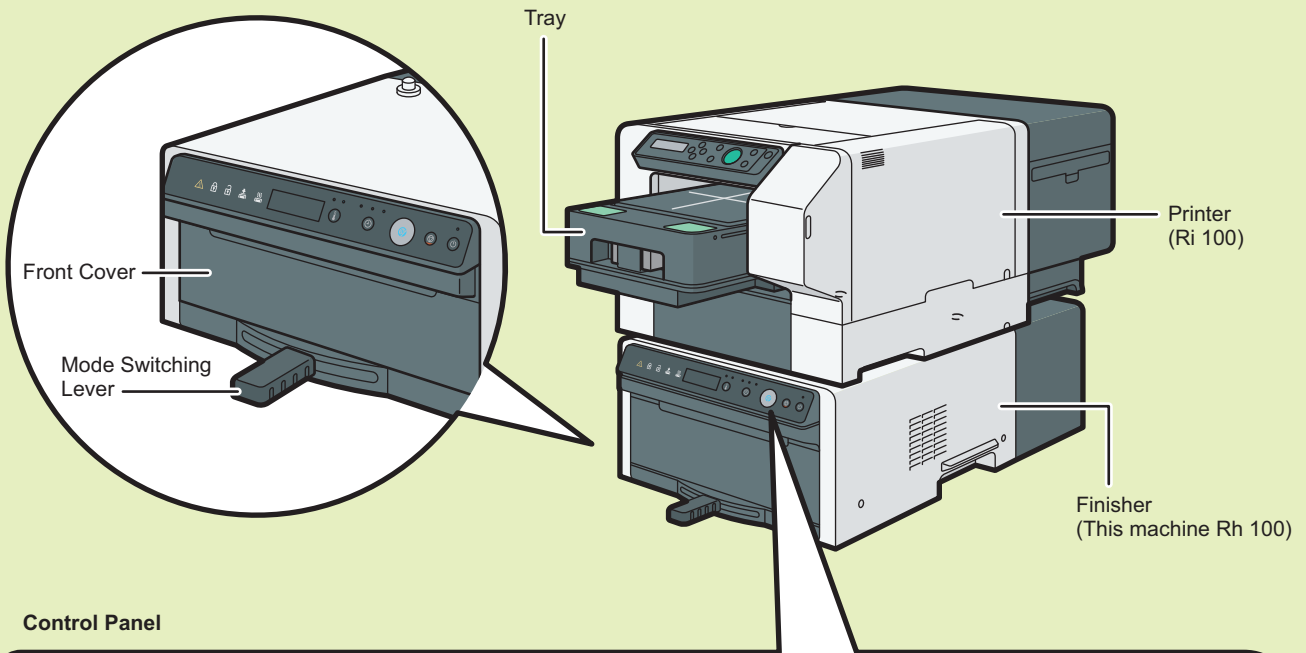

Control Panel

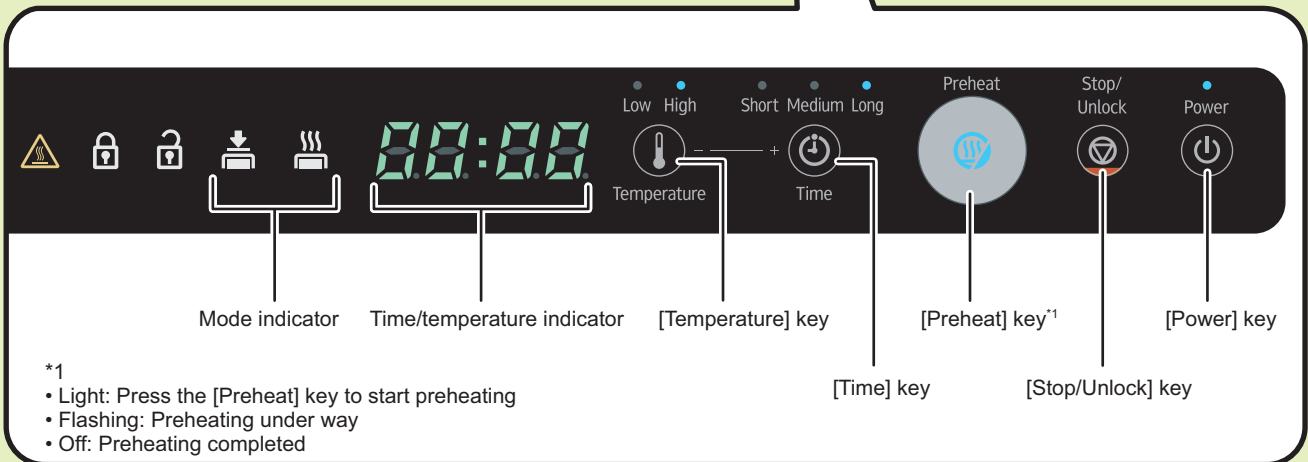

- \*1
- Light: Press the [Preheat] key to start preheating
  - Flashing: Preheating under way
  - Off: Preheating completed

DYX362

# Basic Usage of the Finisher

## ⚠ CAUTION:

- A parent or guardian must be present if infants, children, or people who need assistance use the machine, and they should be very careful when using it. Otherwise, injury or burns may result.

The finisher has “Standard mode”, “Professional mode”, and “Professional 2 mode”.

### ◆ **Standard mode**

The factory-default setting is standard mode. The finisher has the following functions to prevent children from touching the inside of the finisher accidentally when it is very hot.

- When the inside of the finisher exceeds 70 °C (158 °F), the front cover locks. To open the front cover, press the [Stop/ Unlock] key for at least 1 second.

The surface of the heater and the fabric are not in contact with each other during the fixing process, so the surface of the heater does not become dirty.

### ◆ **Professional mode**

To use this mode, switch from standard mode.

As this mode is for users who are accustomed to using the finisher, the front cover does not lock even when the temperature of the inside of the finisher exceeds 70 °C (158 °F).

However, during press processing and fixing processing, the front cover locks regardless of whatever mode is used to prevent erroneous operations.

The surface of the heater and the fabric are not in contact with each other during the fixing process, so the surface of the heater does not become dirty.

### ◆ **Professional 2 mode**

This mode minimizes the loss of color when T-shirts are washed.

To use this mode, switch from professional mode.

As this mode is for users who are accustomed to using the finisher, the front cover does not lock even when the temperature of the inside of the finisher exceeds 70 °C (158 °F).

However, during press processing and fixing processing, the front cover locks regardless of whatever mode is used to prevent erroneous operations.

The surface of the heater and the fabric are in contact with each other during the fixing process, so regular cleaning of the surface of the heater is necessary.

\* Refer to Operating Instructions for cleaning frequency and precautions.

◆ **How to Switch Modes**

Press the [Temperature] key and [Time] key simultaneously for at least 2 seconds.

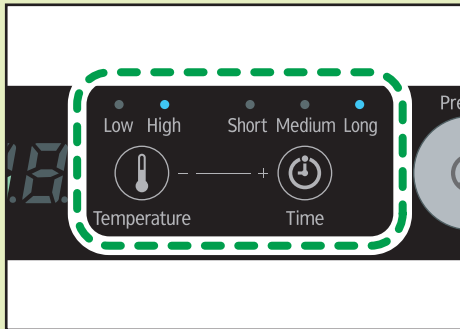

DYX353

The operating mode changes as follows.

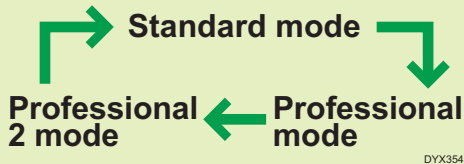

DYX354

◆ **Unlock Cover**

When set to standard mode, press the [Stop/ Unlock] key for at least 1 second.

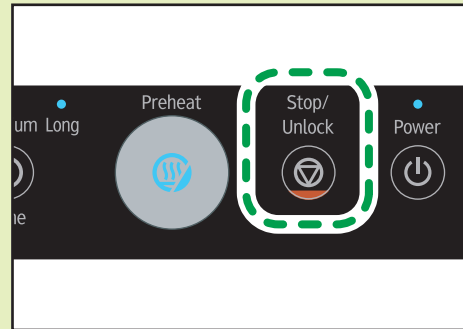

DYX360

When set to the professional mode, it is not necessary to hold down the [Stop/Unlock] key.

# Operating Procedure

Perform the procedures in the order of 1, 2, 3, and then 4.

The following settings and procedures are examples for major fabrics.

Depending on your environment, discoloration may occur or the ink may not be fixed properly. Before configure the settings, check the fixability of the fabric you use.

Fabric type	Mode	Temperature	1. Preparation	2. Pressing	3. Printing	4. Fixing
T-shirt	Standard mode	170°C (338°F)	See next page.	30sec	See Ri 100 Operating Instructions.	3min
	Professional mode			30sec		30sec ↓ 3min
Tote bag (thick)	Standard mode	170°C (338°F)		30sec		3min
Tote bag (thin)	Professional mode	150°C (302°F)		30sec		3min
Sweatshirts		170°C (338°F)		30sec		3min

# Preparation

## Loading the fabric in the tray

**For details, refer to User's Guide provided with the printer Ri 100.**

You can shorten the processing time by putting a garment in the tray while preheating the finisher.

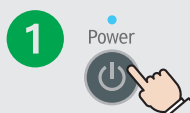

Press the [Power] key to turn on the power..



Make sure the mode switching lever is set in the center.

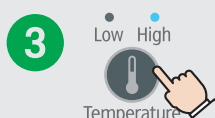

Set the temperature of the heater.  
Set the temperature according to the fabric on which you are printing. The default setting is "High"



Set the amount of time that the heater is on.  
Set the time according to the fabric on which you are printing. The default setting is "Medium".



When the [Preheat] key is lit, press the [Preheat] key to start preheating.  
When the [Preheat] key is unlit, no operation is necessary because preheating is completed.

## Procedure for ( )



When you move the mode switching lever to the left, processing starts. An alarm sounds after preheating is completed.



## Procedure for ( )



When you move the mode switching lever to the right, processing starts. An alarm sounds after preheating is completed.

