

RICOH 2000
How to
Load New
RICOH Type
G2 White Ink

RICOH
imagine. change.

Version 1.0
Date

**NEW
VERSION!**



Introduction

This TD&R document is intended to aid RICOH DTG users how load Ricoh's new Type G2 white ink.

Previously White Ink Cartridges for the Ri 2000 were:

342520 Garment Ink Cartridge White 1 Type G1

342521 Garment Ink Cartridge White 2 Type G1

342600 Garment Ink Cartridge White 1 (Hi Yield) Type G1

342601 Garment Ink Cartridge White 2 (Hi Yield) Type G1

The new improved ink cartridges are:

342836 Enhanced Garment Ink Cartridge White 1 Type G2

342837 Enhanced Garment Ink Cartridge White 2 Type G2

342812 Enhanced Garment Ink Cartridge White 1 (Hi Yield) Type G2

342813 Enhanced Garment Ink Cartridge White 2 (Hi Yield) Type G2

Needed for recommended flushing

QTY 2 342526 RICOH Cleaning Cartridge White 1

QTY 2 342527 RICOH Cleaning Cartridge White 2

Important note: Prior to changing from type G1 to type G2 white ink – confirm that the nozzle check is good. If there are many missing nozzles, the process of changing over to type G2 ink will not necessarily resolve any preexisting clogging or other issue: Please refer to this article on our knowledge base for tips on how to recover the nozzles.

<https://ricohdtg.com/support/ri-2000-head-recovery-guide>

RICOH newest white ink technology sets a new standard for quality and performance. RICOH White ink Type G2 has superior vibrancy and durability to environmental conditions.

Improvements

- Increase in vibrancy between prints
- Less settlement within cartridges and ink lines
- Improvement in nozzle jetting performance
- Improvements in durability to environmental conditions.

Loading White ink

When switching to the new RICOH Type G2 ink there are a few things you need to consider when switching.

1. **All cartridges must be switched at once**. We can NOT have different white ink (Type G1 and G2) cartridges in the same machine. Print results will not be good and it may lead to nozzle loss. This means all white ink cartridges need to be matching.
2. **Option 1 - It is recommended that you fully flush out the old type G1 white ink prior to loading the new type G2 white ink.** – This will allow you to enjoy all the benefits of the new white ink right away. This means you will need Cleaning cartridges to flush the machine. You will need Full cleaning carts for W1B and W2B and at least 50% for the W1A and W2A to perform the two-step flushing process described later in this article.
3. **Option 2** - You can also just perform just the 1st flush prior to refilling with White Type G2 ink which requires less cleaning fluid but does not fully flush the lines. Depending on the age of the printer or carriage this may be adequate.
4. **Option 3** - You can also skip the flushing process and just put in the new Type G2 white ink cartridges. This will require at least **5 strong** cleans on all 4 white heads to be performed after inserting the new cartridges. This will not harm the machine, but you may notice nozzle loss and might need to flush the lines to bring them back.

Flushing the printer for Option 1 or Option 2

1. Check the level of the waste tank – if it is near full then you will need to empty it to prevent the flushing process from failing. In this case, make sure you empty your waste ink bottle and reset the counter.

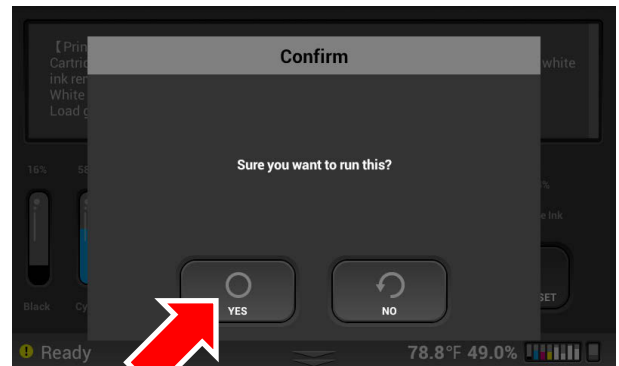
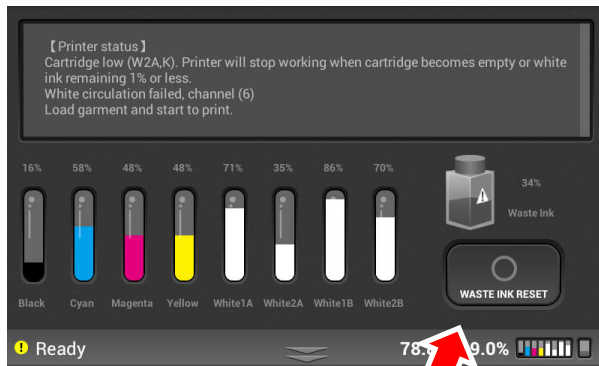

2. Remove all ink cartridges from the printer.



3. Insert your cleaning cartridges.

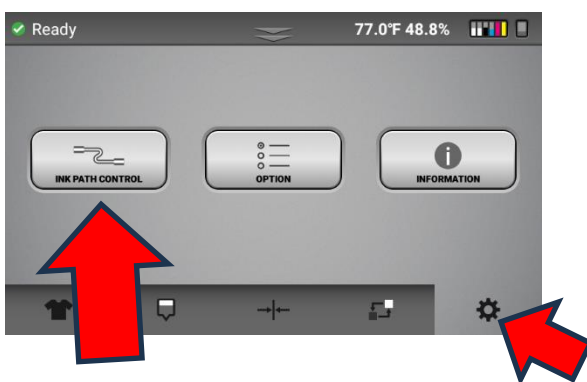

4. Go to the **settings** menu, Select **ink path control**



5. Select **Cleaner Charging**

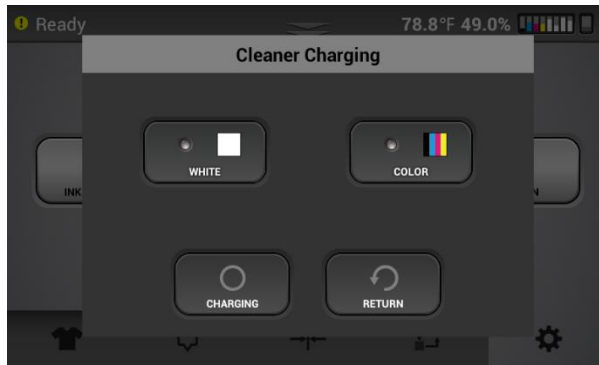

6. You have the option to flush the white carriage, the CMYK carriage, or both carriages. We will just flush the white carriage.

The flush process will take some time to complete.

7. The full Ri 2000 printer flush will have two flushes for the white carriage.

The first flush will take about 30 minutes and will pull only a small amount of cleaning liquid into the tubes but will not clear the entire line of ink. If left in this state, the machine will continue to perform **head cleans** in your white channels. This can be helpful when dealing with clogged nozzles. Over time (days) the head cleans will clear the entire ink line and fill it with cleaning solution making the tubes fully transparent. In this state you can run head cleans and nozzle checks with cleaning fluid. **Option 2 - You can refill with the new White type G2 ink after the 1st flush, but you may not get the full benefit for some time.**

Running Second flush Option 1 Recommended – *Second flush is necessary if you are storing the machine and powering off or switching inks.* The printer will allow you to perform the flush a second time, this second flush will fully flush the ink lines. After about an hour, when the second flush has been completed, your ink lines should now be clear. In this state the printer will not perform auto maintenance and will not allow to print nozzle checks.

#8 Visual inspection

After the flush has been completed check your ink lines visually to make sure they have flushed out completely. The white lines should be fully transparent when the 2nd flush is performed. If just the 1st flush is performed, you will see some white ink or “milky” cleaning fluid inside.

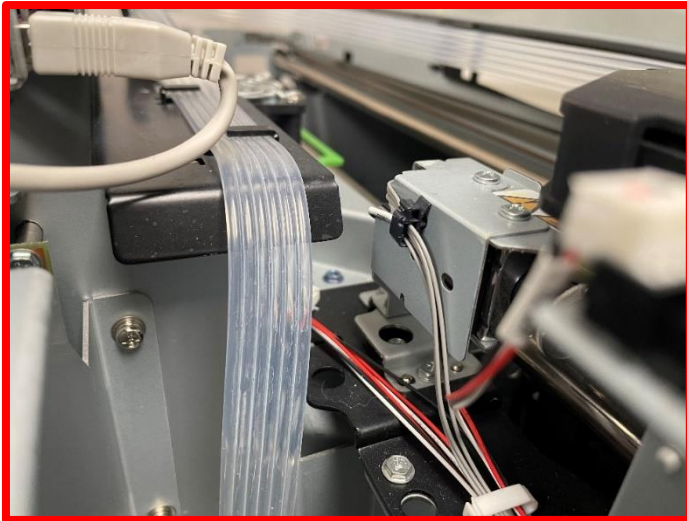

White carriage lines should be fully clear after the 2nd flush. If you are just doing the initial flush, then the lines will still have milky appearance

Ri2000 White lines
completely clear

Filling printer with White Type G2 ink

Shake white ink for 100 seconds

Before inserting the cartridges into the printer, we need to shake the cartridge for 100 seconds, 2 time per second (200 total shakes). This will mix the pigment back around and is an important step to avoid loading settled ink.

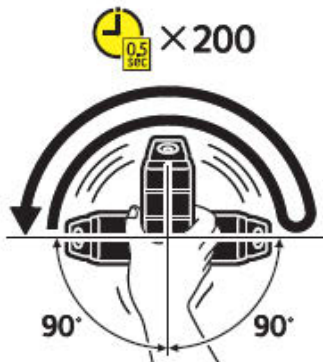

If you have flushed your printer, then refill with white ink as shown below.

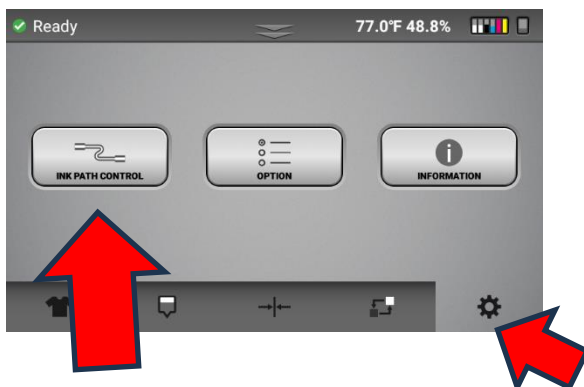

Go to settings, Then go to Ink path control.



Select Ink charging. Then select White channels.

Filling printer with White Type G2 Ink

The fill process will take about 50 minutes to complete. Once the fill has been completed. Print a nozzle check. If the nozzle check is 100% or near 100% you have completed the ink switch. If there are a few missing nozzles, then perform head cleans as described in the manual.